

**EFFECTIVE AFTER MAR 20, 2014**  
**ms Noordam**

**DECK PLANS & STATEROOMS**

The deck plans are color-coded by category of stateroom, and the category letter precedes the stateroom number in each room. All staterooms are equipped with flat-panel television, DVD player, mini-bar, mini-safe, data port, telephone and multichannel music.

**Important Note:** Not all staterooms within each category have the same furniture configuration and/or facilities. Appropriate symbols within the rooms on the deck plans describe differences from the stateroom descriptions below.

All information is subject to change.

**STATEROOM SYMBOL LEGEND**

- Triple (2 lower beds, 1 sofa bed)
- Quad (2 lower beds, 1 sofa bed, 1 upper)
- △ Partial sea view
- × Fully obstructed view
- + Connecting rooms
- \* Shower only
- ♠ Single sink vanity
- ◆ Staterooms have solid steel verandah railings instead of clear-view Plexiglas® railings
- ♿ Suites SY8068, SC6175, SC6164, SY5002 & SY5001 are wheelchair accessible, bathtub and roll-in shower. Suite SS6108 and staterooms I-8037, VA8032, VA8031, VA6049, VB6004, VB6003, VA5140, VA5137, VA5054, VA5051, VA4132, VA4131, H4090, H4089, VA4052, VA4051, D1100, C1082, C1081, J1074, K1012 & K1011 are wheelchair accessible, roll-in shower only.

**OCEAN-VIEW STATEROOMS**

**C D DD E F**  
**Large:** 2 lower beds convertible to 1 queen-size bed, bathtub & shower.  
Approximately 174–180 sq. ft.

**INTERIOR STATEROOMS**

**J**  
**Large:** 2 lower beds convertible to 1 queen-size bed, shower.  
Approximately 151–233 sq. ft.

**K**  
**Large or Standard:** 2 lower beds convertible to 1 queen-size bed, shower.  
Approximately 151–233 sq. ft.

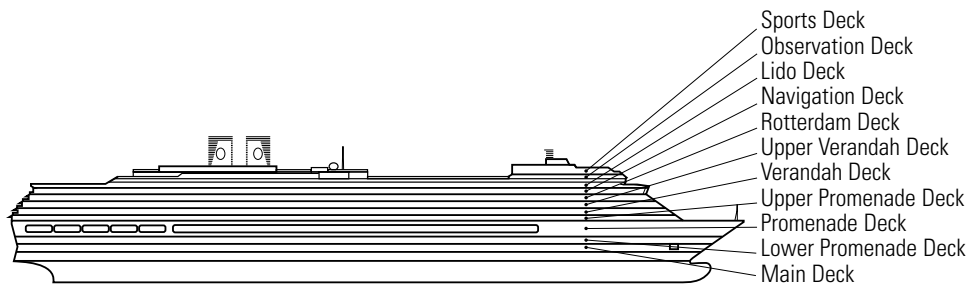

**DECK 1 – MAIN DECK**  
Staterooms 1001–1127

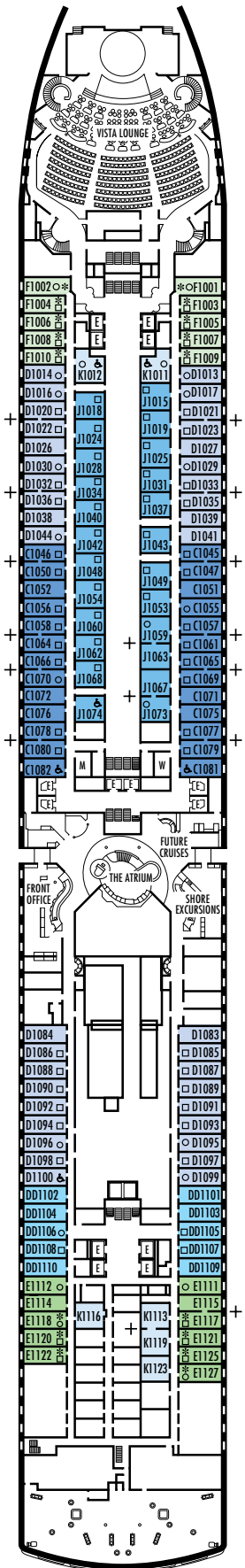

**EFFECTIVE AFTER MAR 20, 2014**  
**ms Noordam**

**DECK PLANS & STATEROOMS**

The deck plans are color-coded by category of stateroom, and the category letter precedes the stateroom number in each room. All staterooms are equipped with flat-panel television, DVD player, mini-bar, mini-safe, data port, telephone and multichannel music.

**Important Note:** Not all staterooms within each category have the same furniture configuration and/or facilities. Appropriate symbols within the rooms on the deck plans describe differences from the stateroom descriptions below.

All information is subject to change.

**STATEROOM SYMBOL LEGEND**

- Triple (2 lower beds, 1 sofa bed)
- Quad (2 lower beds, 1 sofa bed, 1 upper)
- △ Partial sea view
- × Fully obstructed view
- + Connecting rooms
- \* Shower only
- ◆ Single sink vanity
- ◆ Staterooms have solid steel verandah railings instead of clear-view Plexiglas® railings
- ♿ Suites SY8068, SC6175, SC6164, SY5002 & SY5001 are wheelchair accessible, bathtub and roll-in shower. Suite SS6108 and staterooms I-8037, VA8032, VA8031, VA6049, VB6004, VB6003, VA5140, VA5137, VA5054, VA5051, VA4132, VA4131, H4090, H4089, VA4052, VA4051, D1100, C1082, C1081, J1074, K1012 & K1011 are wheelchair accessible, roll-in shower only.

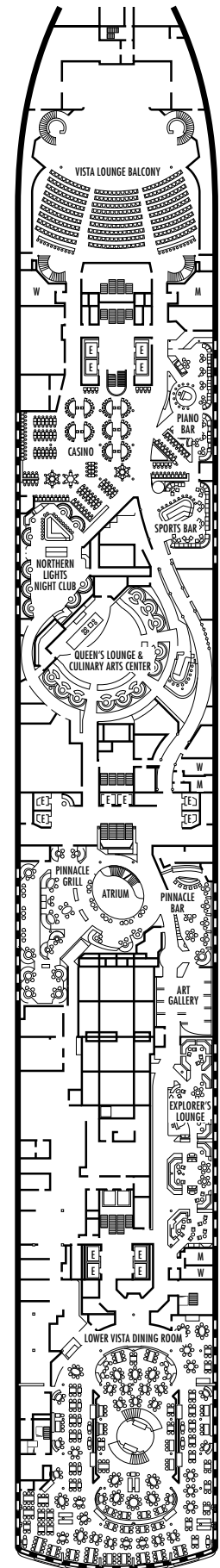
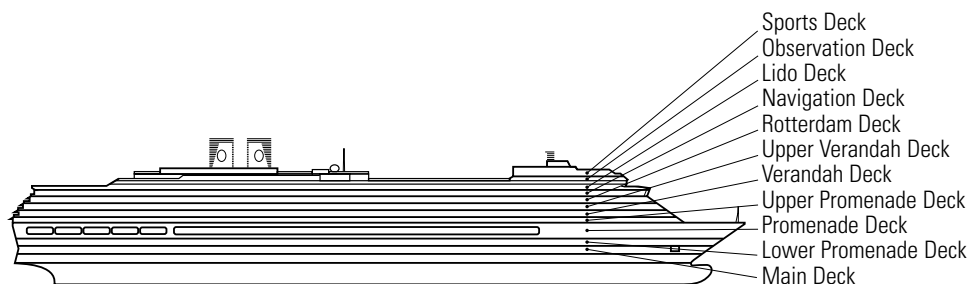

**EFFECTIVE AFTER MAR 20, 2014**  
**ms Noordam**

**DECK PLANS & STATEROOMS**

The deck plans are color-coded by category of stateroom, and the category letter precedes the stateroom number in each room. All staterooms are equipped with flat-panel television, DVD player, mini-bar, mini-safe, data port, telephone and multichannel music.

**Important Note:** Not all staterooms within each category have the same furniture configuration and/or facilities. Appropriate symbols within the rooms on the deck plans describe differences from the stateroom descriptions below.

All information is subject to change.

**STATEROOM SYMBOL LEGEND**

- Triple (2 lower beds, 1 sofa bed)
- Quad (2 lower beds, 1 sofa bed, 1 upper)
- △ Partial sea view
- × Fully obstructed view
- + Connecting rooms
- \* Shower only
- ◆ Single sink vanity
- ◆ Staterooms have solid steel verandah railings instead of clear-view Plexiglas® railings
- ♿ Suites SY8068, SC6175, SC6164, SY5002 & SY5001 are wheelchair accessible, bathtub and roll-in shower. Suite SS6108 and staterooms I-8037, VA8032, VA8031, VA6049, VB6004, VB6003, VA5140, VA5137, VA5054, VA5051, VA4132, VA4131, H4090, H4089, VA4052, VA4051, D1100, C1082, C1081, J1074, K1012 & K1011 are wheelchair accessible, roll-in shower only.

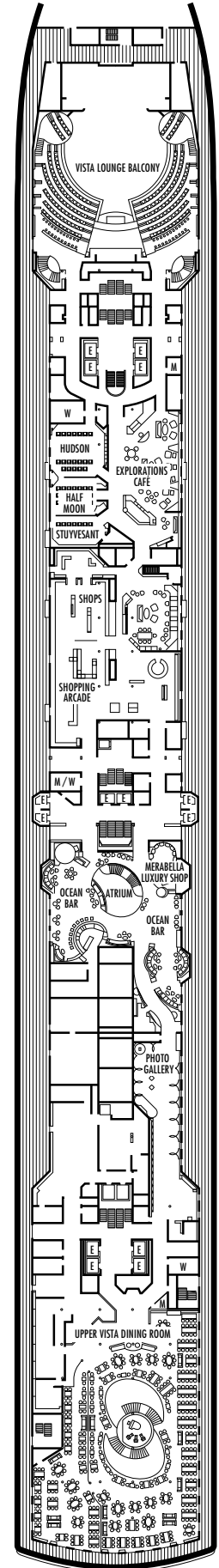
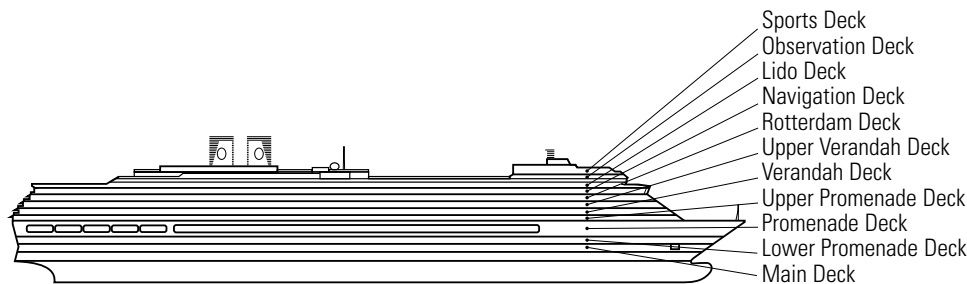

**EFFECTIVE AFTER MAR 20, 2014**  
**ms Noordam**

**DECK PLANS & STATEROOMS**

The deck plans are color-coded by category of stateroom, and the category letter precedes the stateroom number in each room. All staterooms are equipped with flat-panel television, DVD player, mini-bar, mini-safe, data port, telephone and multichannel music.

**Important Note:** Not all staterooms within each category have the same furniture configuration and/or facilities. Appropriate symbols within the rooms on the deck plans describe differences from the stateroom descriptions below.

All information is subject to change.

**STATEROOM SYMBOL LEGEND**

- Triple (2 lower beds, 1 sofa bed)
- Quad (2 lower beds, 1 sofa bed, 1 upper)
- △ Partial sea view
- × Fully obstructed view
- + Connecting rooms
- \* Shower only
- ◆ Single sink vanity
- ♿ Suites SY8068, SC6175, SC6164, SY5002 & SY5001 are wheelchair accessible, bathtub and roll-in shower. Suite SS6108 and staterooms I-8037, VA8032, VA8031, VA6049, VB6004, VB6003, VA5140, VA5137, VA5054, VA5051, VA4132, VA4131, H4090, H4089, VA4052, VA4051, D1100, C1082, C1081, J1074, K1012 & K1011 are wheelchair accessible, roll-in shower only.

**VERANDAH SUITES**

**SB**  
**Neptune Suites:** (Deluxe Verandah Suites)  
2 lower beds convertible to 1 king-size bed, bathroom with dual sink vanity, full-size whirlpool bath & shower & additional shower stall, large sitting area, dressing room, private verandah, 1 sofa bed for 2 persons, floor-to-ceiling windows. Approximately 500–712 sq. ft. including verandah.

**VERANDAH STATEROOMS**

**VA VB VC VE VF VH**  
**Verandah:** (Deluxe Verandah Ocean-view)  
2 lower beds convertible to 1 queen-size bed, bathtub & shower, sitting area, private verandah, floor-to-ceiling windows. Approximately 212–359 sq. ft. including verandah.

**OCEAN-VIEW STATEROOMS**

**D**  
**Large:** 2 lower beds convertible to 1 queen-size bed, bathtub & shower. Approximately 174–180 sq. ft.  
**G H HH**  
**Large:** 2 lower beds convertible to 1 queen-size bed, bathtub & shower. All G-category staterooms have partial sea views. All H- & HH-category staterooms have fully obstructed views. Approximately 174–180 sq. ft.

**INTERIOR STATEROOMS**

**K**  
**Large or Standard:** 2 lower beds convertible to 1 queen-size bed, shower. Approximately 151–233 sq. ft.  
**L N**  
**Standard:** 2 lower beds convertible to 1 queen-size bed, shower. Approximately 151–233 sq. ft.

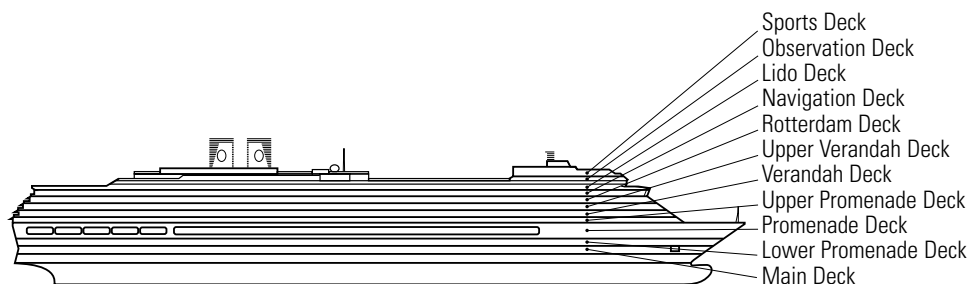
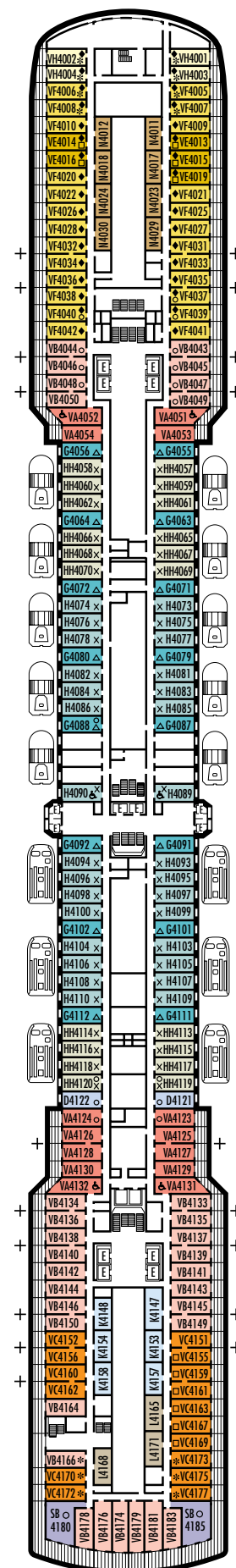

**EFFECTIVE AFTER MAR 20, 2014**  
**ms Noordam**

**DECK PLANS & STATEROOMS**

The deck plans are color-coded by category of stateroom, and the category letter precedes the stateroom number in each room. All staterooms are equipped with flat-panel television, DVD player, mini-bar, mini-safe, data port, telephone and multichannel music.

**Important Note:** Not all staterooms within each category have the same furniture configuration and/or facilities. Appropriate symbols within the rooms on the deck plans describe differences from the stateroom descriptions below.

All information is subject to change.

**STATEROOM SYMBOL LEGEND**

- Triple (2 lower beds, 1 sofa bed)
- Quad (2 lower beds, 1 sofa bed, 1 upper)
- △ Partial sea view
- × Fully obstructed view
- + Connecting rooms
- \* Shower only
- ♠ Single sink vanity
- ◆ Staterooms have solid steel verandah railings instead of clear-view Plexiglas® railings
- ♿ Suites SY8068, SC6175, SC6164, SY5002 & SY5001 are wheelchair accessible, bathtub and roll-in shower. Suite SS6108 and staterooms I-8037, VA8032, VA8031, VA6049, VB6004, VB6003, VA5140, VA5137, VA5054, VA5051, VA4132, VA4131, H4090, H4089, VA4052, VA4051, D1100, C1082, C1081, J1074, K1012 & K1011 are wheelchair accessible, roll-in shower only.

**VERANDAH SUITES**

**SB**  
**Neptune Suites:** (Deluxe Verandah Suites)  
2 lower beds convertible to 1 king-size bed, bathroom with dual sink vanity, full-size whirlpool bath & shower & additional shower stall, large sitting area, dressing room, private verandah, 1 sofa bed for 2 persons, floor-to-ceiling windows. Approximately 500–712 sq. ft. including verandah.

**SY**  
**Signature Suites:** (Superior Verandah Suites)  
2 lower beds convertible to 1 queen-size bed, bathroom with dual sink vanity, full-size whirlpool bath & shower & additional shower stall, large sitting area, private verandah, 1 sofa bed for 1 person, floor-to-ceiling windows. Approximately 372–384 sq. ft. including verandah.

**VERANDAH STATEROOMS**

**VA VB VC**  
**Verandah:** (Deluxe Verandah Ocean-view)  
2 lower beds convertible to 1 queen-size bed, bathtub & shower, sitting area, private verandah, floor-to-ceiling windows. Approximately 212–359 sq. ft. including verandah.

**INTERIOR STATEROOMS**

**K**  
**Large or Standard:** 2 lower beds convertible to 1 queen-size bed, shower. Approximately 151–233 sq. ft.

**L**  
**Standard:** 2 lower beds convertible to 1 queen-size bed, shower. Approximately 151–233 sq. ft.

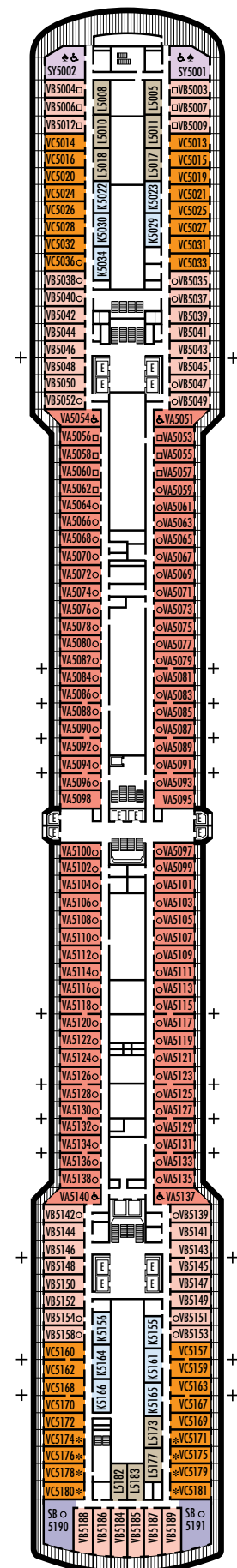
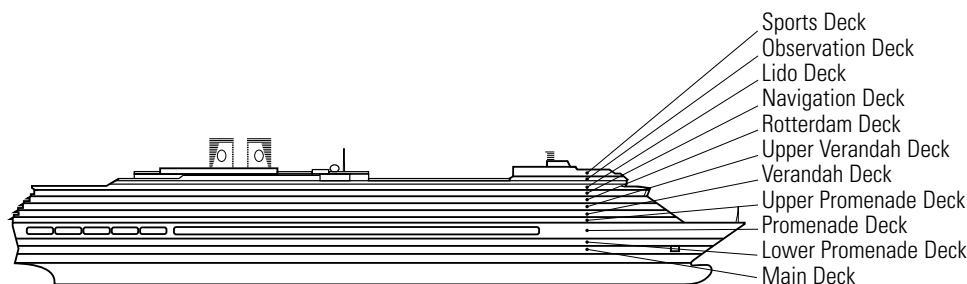

**EFFECTIVE AFTER MAR 20, 2014**  
**ms Noordam**

**DECK PLANS & STATEROOMS**

The deck plans are color-coded by category of stateroom, and the category letter precedes the stateroom number in each room. All staterooms are equipped with flat-panel television, DVD player, mini-bar, mini-safe, data port, telephone and multichannel music.

**Important Note:** Not all staterooms within each category have the same furniture configuration and/or facilities. Appropriate symbols within the rooms on the deck plans describe differences from the stateroom descriptions below.

All information is subject to change.

**STATEROOM SYMBOL LEGEND**

- Triple (2 lower beds, 1 sofa bed)
- Quad (2 lower beds, 1 sofa bed, 1 upper)
- △ Partial sea view
- X Fully obstructed view
- + Connecting rooms
- \* Shower only
- ♠ Single sink vanity
- ◆ Staterooms have solid steel verandah railings instead of clear-view Plexiglas® railings
- ♿ Suites SY8068, SC6175, SC6164, SY5002 & SY5001 are wheelchair accessible, bathtub and roll-in shower. Suite SS6108 and staterooms I-8037, VA8032, VA8031, VA6049, VB6004, VB6003, VA5140, VA5137, VA5054, VA5051, VA4132, VA4131, H4090, H4089, VA4052, VA4051, D1100, C1082, C1081, J1074, K1012 & K1011 are wheelchair accessible, roll-in shower only.

**VERANDAH SUITES**

**SB SC**

**Neptune Suites:** (Deluxe Verandah Suites)  
2 lower beds convertible to 1 king-size bed, bathroom with dual sink vanity, full-size whirlpool bath & shower & additional shower stall, large sitting area, dressing room, private verandah, 1 sofa bed for 2 persons, floor-to-ceiling windows. Approximately 500–712 sq. ft. including verandah.

**SS**

**Signature Suites:** (Superior Verandah Suites)  
2 lower beds convertible to 1 queen-size bed, bathroom with dual sink vanity, full-size whirlpool bath & shower & additional shower stall, large sitting area, private verandah, 1 sofa bed for 1 person, floor-to-ceiling windows. Approximately 372–384 sq. ft. including verandah.

**VERANDAH STATEROOMS**

**VA VB VC VD**

**Verandah:** (Deluxe Verandah Ocean-view)  
2 lower beds convertible to 1 queen-size bed, bathtub & shower, sitting area, private verandah, floor-to-ceiling windows. Approximately 213–359 sq. ft. including verandah.

**OCEAN-VIEW STATEROOMS**

**F**

**Large:** 2 lower beds convertible to 1 queen-size bed, bathtub & shower. Approximately 174–180 sq. ft.

**INTERIOR STATEROOMS**

**I K L**

**Large or Standard:** 2 lower beds convertible to 1 queen-size bed, shower. Approximately 151–233 sq. ft.

**L**

**Standard:** 2 lower beds convertible to 1 queen-size bed, shower. Approximately 151–233 sq. ft.

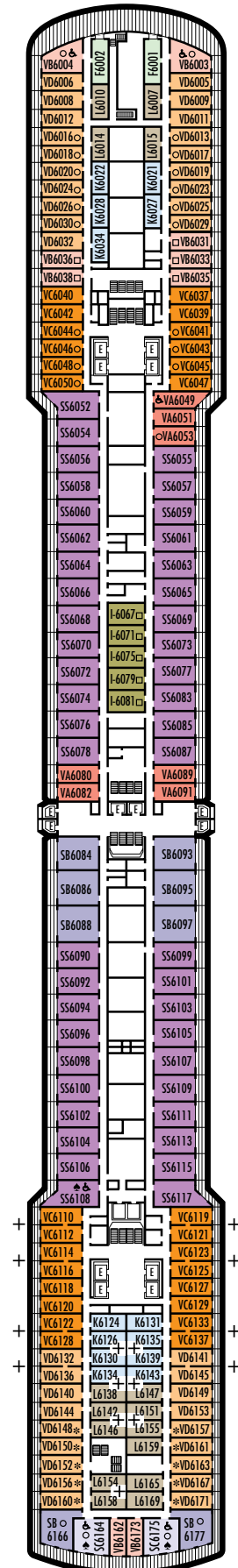
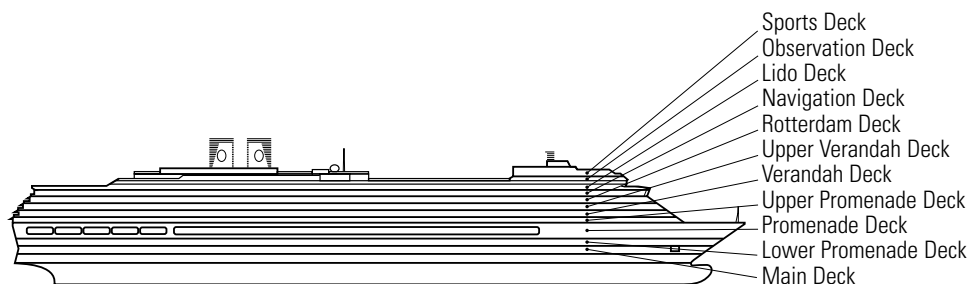

**EFFECTIVE AFTER MAR 20, 2014**  
**ms Noordam**

**DECK PLANS & STATEROOMS**

The deck plans are color-coded by category of stateroom, and the category letter precedes the stateroom number in each room. All staterooms are equipped with flat-panel television, DVD player, mini-bar, mini-safe, data port, telephone and multichannel music.

**Important Note:** Not all staterooms within each category have the same furniture configuration and/or facilities. Appropriate symbols within the rooms on the deck plans describe differences from the stateroom descriptions below.

All information is subject to change.

**STATEROOM SYMBOL LEGEND**

- Triple (2 lower beds, 1 sofa bed)
- Quad (2 lower beds, 1 sofa bed, 1 upper)
- △ Partial sea view
- × Fully obstructed view
- + Connecting rooms
- \* Shower only
- ♠ Single sink vanity
- ◆ Staterooms have solid steel verandah railings instead of clear-view Plexiglas® railings
- ♿ Suites SY8068, SC6175, SC6164, SY5002 & SY5001 are wheelchair accessible, bathtub and roll-in shower. Suite SS6108 and staterooms I-8037, VA8032, VA8031, VA6049, VB6004, VB6003, VA5140, VA5137, VA5054, VA5051, VA4132, VA4131, H4090, H4089, VA4052, VA4051, D1100, C1082, C1081, J1074, K1012 & K1011 are wheelchair accessible, roll-in shower only.

**VERANDAH SUITES**

**PS**  
**Pinnacle Suites:** (Penthouse Verandah Suites) Bedroom with 1 king-size bed, oversize whirlpool bath & shower & additional shower stall, living room, dining room, dressing room, private verandah with whirlpool, pantry, 1 sofa bed for 2 persons, microwave, refrigerator, guest toilet, private stereo system, floor-to-ceiling windows. Approximately 1,150 sq. ft. including verandah.

**SA SB SC**  
**Neptune Suites:** (Deluxe Verandah Suites) 2 lower beds convertible to 1 king-size bed, bathroom with dual sink vanity, full-size whirlpool bath & shower & additional shower stall, large sitting area, dressing room, private verandah, 1 sofa bed for 2 persons, floor-to-ceiling windows. Approximately 500–712 sq. ft. including verandah.

**VERANDAH STATEROOMS**

**VB VD VE**  
**Verandah:** (Deluxe Verandah Ocean-view) 2 lower beds convertible to 1 queen-size bed, bathtub & shower, sitting area, private verandah, floor-to-ceiling windows. Approximately 212–359 sq. ft. including verandah.

**INTERIOR STATEROOMS**

**I**  
**Large or Standard:** 2 lower beds convertible to 1 queen-size bed, shower. Approximately 151–233 sq. ft.

**L M**  
**Standard:** 2 lower beds convertible to 1 queen-size bed, shower. Approximately 151–233 sq. ft.

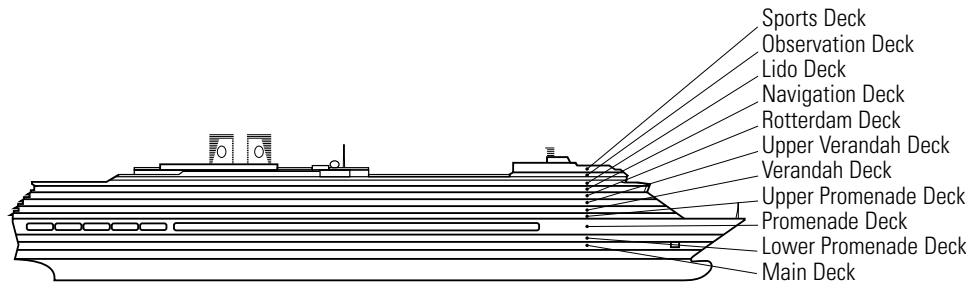
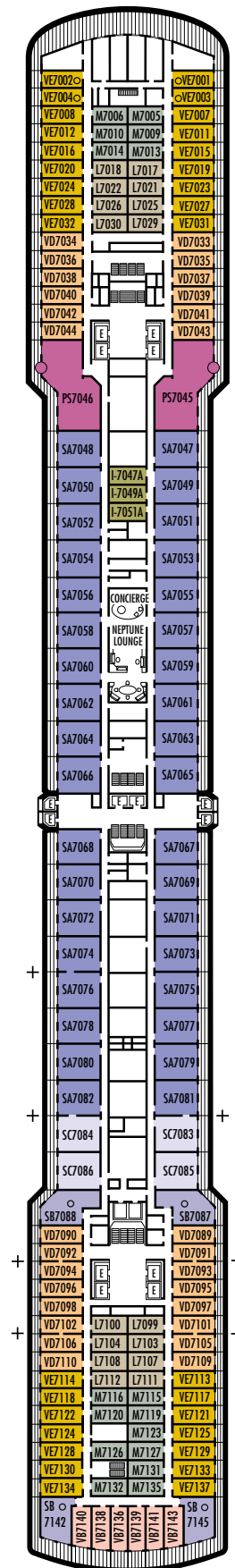

**EFFECTIVE AFTER MAR 20, 2014**  
**ms Noordam**

**DECK PLANS & STATEROOMS**

The deck plans are color-coded by category of stateroom, and the category letter precedes the stateroom number in each room. All staterooms are equipped with flat-panel television, DVD player, mini-bar, mini-safe, data port, telephone and multichannel music.

**Important Note:** Not all staterooms within each category have the same furniture configuration and/or facilities. Appropriate symbols within the rooms on the deck plans describe differences from the stateroom descriptions below.

All information is subject to change.

**STATEROOM SYMBOL LEGEND**

- Triple (2 lower beds, 1 sofa bed)
- Quad (2 lower beds, 1 sofa bed, 1 upper)
- △ Partial sea view
- × Fully obstructed view
- + Connecting rooms
- \* Shower only
- ♠ Single sink vanity
- ◆ Staterooms have solid steel verandah railings instead of clear-view Plexiglas® railings
- ♿ Suites SY8068, SC6175, SC6164, SY5002 & SY5001 are wheelchair accessible, bathtub and roll-in shower. Suite SS6108 and staterooms I-8037, VA8032, VA8031, VA6049, VB6004, VB6003, VA5140, VA5137, VA5054, VA5051, VA4132, VA4131, H4090, H4089, VA4052, VA4051, D1100, C1082, C1081, J1074, K1012 & K1011 are wheelchair accessible, roll-in shower only.

**VERANDAH SUITES**

**SB**  
**Neptune Suites:** (Deluxe Verandah Suites)  
2 lower beds convertible to 1 king-size bed, bathroom with dual sink vanity, full-size whirlpool bath & shower & additional shower stall, large sitting area, dressing room, private verandah, 1 sofa bed for 2 persons, floor-to-ceiling windows. Approximately 500–712 sq. ft. including verandah.

**SY SZ**  
**Signature Suites:** (Superior Verandah Suites)  
2 lower beds convertible to 1 queen-size bed, bathroom with dual sink vanity, full-size whirlpool bath & shower & additional shower stall, large sitting area, private verandah, 1 sofa bed for 1 person, floor-to-ceiling windows. Approximately 372–384 sq. ft. including verandah.

**VERANDAH STATEROOMS**

**VA VC VE VF**  
**Verandah:** (Deluxe Verandah Ocean-view)  
2 lower beds convertible to 1 queen-size bed, bathtub & shower, sitting area, private verandah, floor-to-ceiling windows. Approximately 212–359 sq. ft. including verandah.

**INTERIOR STATEROOMS**

**I MM**  
**Large or Standard:** 2 lower beds convertible to 1 queen-size bed, shower. Approximately 151–233 sq. ft.

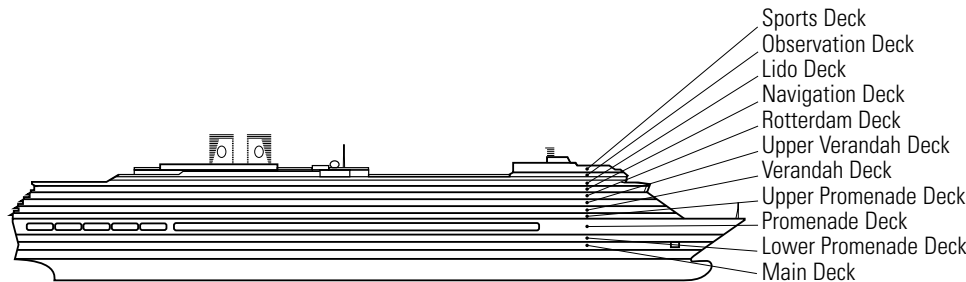
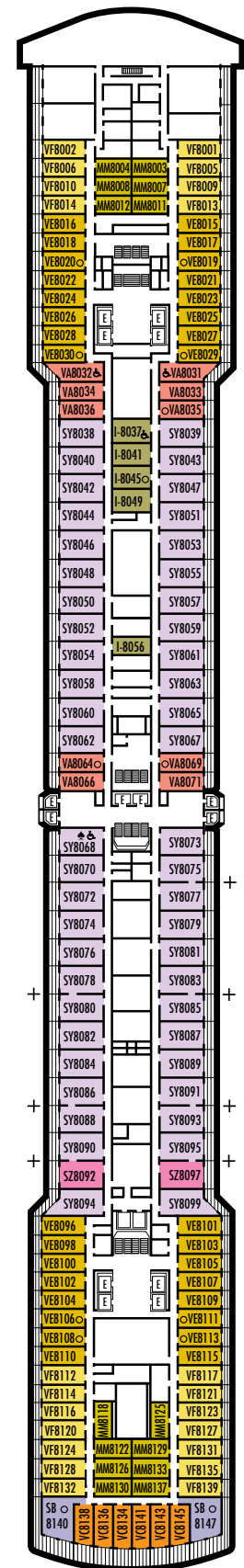



**EFFECTIVE AFTER MAR 20, 2014**  
**ms Noordam**

**DECK PLANS & STATEROOMS**

The deck plans are color-coded by category of stateroom, and the category letter precedes the stateroom number in each room. All staterooms are equipped with flat-panel television, DVD player, mini-bar, mini-safe, data port, telephone and multichannel music.

**Important Note:** Not all staterooms within each category have the same furniture configuration and/or facilities. Appropriate symbols within the rooms on the deck plans describe differences from the stateroom descriptions below.

All information is subject to change.

**STATEROOM SYMBOL LEGEND**

- Triple (2 lower beds, 1 sofa bed)
- Quad (2 lower beds, 1 sofa bed, 1 upper)
- △ Partial sea view
- × Fully obstructed view
- + Connecting rooms
- \* Shower only
- ◆ Single sink vanity
- ◆ Staterooms have solid steel verandah railings instead of clear-view Plexiglas® railings
- ♿ Suites SY8068, SC6175, SC6164, SY5002 & SY5001 are wheelchair accessible, bathtub and roll-in shower. Suite SS6108 and staterooms I-8037, VA8032, VA8031, VA6049, VB6004, VB6003, VA5140, VA5137, VA5054, VA5051, VA4132, VA4131, H4090, H4089, VA4052, VA4051, D1100, C1082, C1081, J1074, K1012 & K1011 are wheelchair accessible, roll-in shower only.

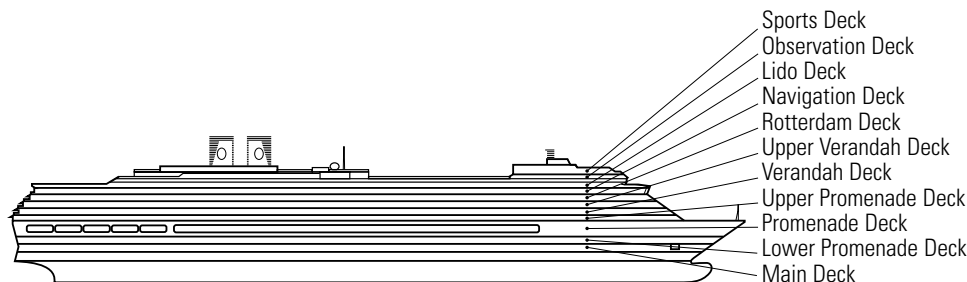
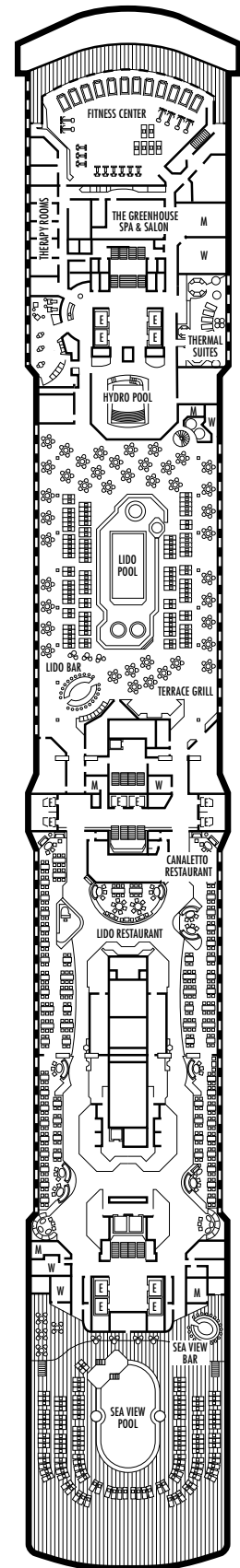

**EFFECTIVE AFTER MAR 20, 2014**  
**ms Noordam**

**DECK PLANS & STATEROOMS**

The deck plans are color-coded by category of stateroom, and the category letter precedes the stateroom number in each room. All staterooms are equipped with flat-panel television, DVD player, mini-bar, mini-safe, data port, telephone and multichannel music.

**Important Note:** Not all staterooms within each category have the same furniture configuration and/or facilities. Appropriate symbols within the rooms on the deck plans describe differences from the stateroom descriptions below.

All information is subject to change.

**STATEROOM SYMBOL LEGEND**

- Triple (2 lower beds, 1 sofa bed)
- Quad (2 lower beds, 1 sofa bed, 1 upper)
- △ Partial sea view
- × Fully obstructed view
- + Connecting rooms
- \* Shower only
- ♠ Single sink vanity
- ◆ Staterooms have solid steel verandah railings instead of clear-view Plexiglas® railings
- ♿ Suites SY8068, SC6175, SC6164, SY5002 & SY5001 are wheelchair accessible, bathtub and roll-in shower. Suite SS6108 and staterooms I-8037, VA8032, VA8031, VA6049, VB6004, VB6003, VA5140, VA5137, VA5054, VA5051, VA4132, VA4131, H4090, H4089, VA4052, VA4051, D1100, C1082, C1081, J1074, K1012 & K1011 are wheelchair accessible, roll-in shower only.

**VERANDAH STATEROOMS**

**VB**

**Verandah:** (Deluxe Verandah Ocean-view)  
2 lower beds convertible to 1 queen-size bed, bathtub & shower, sitting area, private verandah, floor-to-ceiling windows.  
Approximately 212–359 sq. ft. including verandah.

**INTERIOR STATEROOMS**

**K**

**Large or Standard:** 2 lower beds convertible to 1 queen-size bed, shower.  
Approximately 151–233 sq. ft.

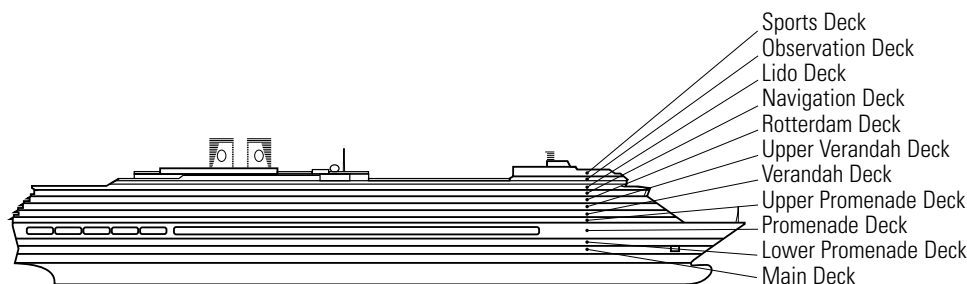
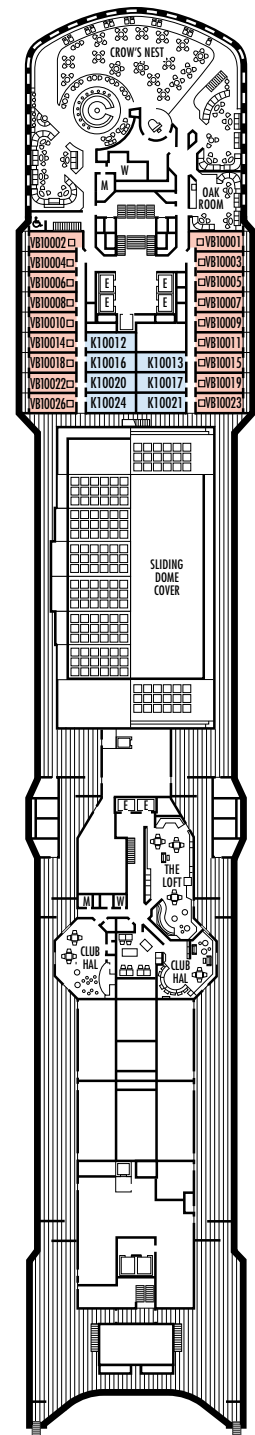

**EFFECTIVE AFTER MAR 20, 2014**  
**ms Noordam**

**DECK PLANS & STATEROOMS**

The deck plans are color-coded by category of stateroom, and the category letter precedes the stateroom number in each room. All staterooms are equipped with flat-panel television, DVD player, mini-bar, mini-safe, data port, telephone and multichannel music.

**Important Note:** Not all staterooms within each category have the same furniture configuration and/or facilities. Appropriate symbols within the rooms on the deck plans describe differences from the stateroom descriptions below.

All information is subject to change.

**STATEROOM SYMBOL LEGEND**

- Triple (2 lower beds, 1 sofa bed)
- Quad (2 lower beds, 1 sofa bed, 1 upper)
- △ Partial sea view
- × Fully obstructed view
- + Connecting rooms
- \* Shower only
- ◆ Single sink vanity
- ◆ Staterooms have solid steel verandah railings instead of clear-view Plexiglas® railings
- ♿ Suites SY8068, SC6175, SC6164, SY5002 & SY5001 are wheelchair accessible, bathtub and roll-in shower. Suite SS6108 and staterooms I-8037, VA8032, VA8031, VA6049, VB6004, VB6003, VA5140, VA5137, VA5054, VA5051, VA4132, VA4131, H4090, H4089, VA4052, VA4051, D1100, C1082, C1081, J1074, K1012 & K1011 are wheelchair accessible, roll-in shower only.

